

**PLAN**  
Scale 1" = 40'

SHEET NO 1  
**PLAN NO 1724**  
 FOR  
**"F" STREET SEWER**  
 BETWEEN  
 THIRTY-SIXTH STREET AND NORTH CITY LIMITS  
 IN THE  
 CITY OF SAN BERNARDINO  
 CALIFORNIA

AUGUST 1947  
 R. D. FORTYNE  
 Acting City Engineer

PLAN ADOPTED July 25, 1948.

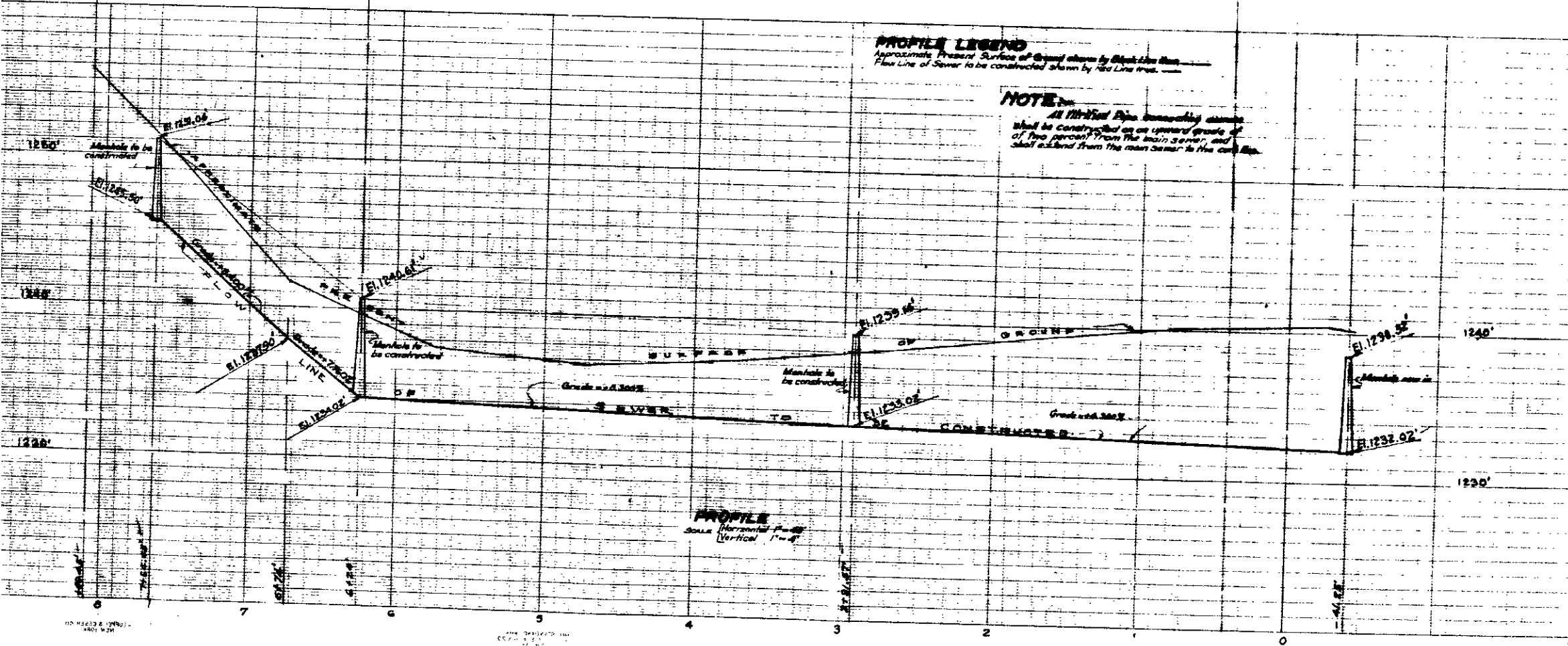
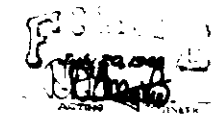

**PROFILE LEGEND**  
 Approximate Present Surface of Ground shown by Dashed Line  
 Flow Line of Sewer to be constructed shown by Solid Line

**NOTE:**  
 All vitrified pipe connecting manholes shall be constructed on an upward grade of not less than two percent from the main sewer, and shall extend from the main sewer to the curb line.

**PROFILE**  
 SCALE: Horizontal 1" = 40'  
 Vertical 1" = 4'

**LEGEND**

- " or in means inch or inches
- ' or ft. means foot or feet.
- N# means number
- CL means Center Line
- E.L. means elevation
- 8" Vitrified Pipe Sewer to be constructed shown thus
- 6" x 4" Vitrified Pipe Sewer to be constructed shown thus
- Manholes to be constructed shown thus
- Manholes to be constructed on another plan shown thus

**SEWER DETAIL**

Lineal Ft. of 8" Vitrified Pipe Sewer to be constructed	685.70
Lineal Ft. of 6" Vitrified Pipe Sewer to be constructed	530.68
N# of 6" x 4" Vitrified with 4" Connecting Sewers to be constructed	22
N# of Manholes to be constructed	3

**TITLE TO STREET**

Title to "F" STREET was dedicated by Thompson Brothers Plating Company Tract 1733 Book 25 Pages 2, 3, 11, and 12.

**GRADE RESOLUTION**

Grade of "F" STREET established by Resolution No. 1657, Dated the 2nd of Sept. 1947 of the City of San Bernardino, California.

**DATUM**

All elevations shown in "Red" ink are in feet and are above a plane which is 1045.80 feet below the City Bench Mark as established by Ordinance 385 of the City of San Bernardino, California.